

**AP MORGAN**



**Redditch Road, Kings Norton, Birmingham**  
Offers in the region of £140,000



**Features:**

- A well-presented ground-floor flat
- Ideally situated in Kings Norton
- Two double bedrooms
- Fitted Kitchen, with space for freestanding appliances
- Generous living room
- Front garden and garage

**Description:**

A well-presented ground-floor flat, situated within the Norton Court apartment complex, on Redditch Road, King's Norton. Ideally positioned, the property provides convenient access to a range of local amenities and is just a short distance from King's Norton high street.

The property is set back from the main road, with a driveway leading to an allocated garage and parking space, allocated to the flat. The property benefits from a front garden, with a path leading to the front door.

The property accommodation comprises a welcoming hallway, providing three cupboards, two generous double bedrooms, the fitted kitchen, with a sink and space for freestanding appliances, spacious living room and bathroom, providing a bath, with an overhead shower, WC and washbasin.

The property benefits from proximity to nearby shops and amenities, with nearby Kings Norton, Cotteridge, and Northfield town providing additional shopping opportunities. The property is also conveniently positioned for travel via road to Birmingham city centre, the M5 and M42 motorways, and beyond. Kings Norton train station is just over one mile away and provides free parking for rail passengers. Several well-regarded primary and secondary schools are also located nearby.



**Details:**

**Hallway**

**Bedroom 1** 17'7" x 8'11" (5.36m x 2.72m)

**Bedroom 2** 14' x 7'11" (4.27m x 2.41m)

**Kitchen** 14' x 6'10" (4.27m x 2.08m)

**Living Room** 17'11" x 9'10" (5.46m x 3m)

**Bathroom** 6'8" x 9'10" (2.03m x 3m)



**EPC Rating:** To be confirmed

**Council Tax Band:** B (tbc by solicitors).

**Tenure:** Leasehold (tbc by solicitors).

For more information or to arrange a viewing, please call us on 0121 827 6827.

How can we help you?

Need a mortgage?

We recommend Wiser Mortgage Advice. They will search the market for you to ensure you get the right lender and mortgage deal. They typically achieve mortgage offers much more quickly than if you were dealing with lenders directly. The initial appointment is free and without obligation. Call us on 0121 827 6827, or visit their website for more information: [www.wisermortgageadvice.co.uk](http://www.wisermortgageadvice.co.uk)

Property to sell?

If you need to sell a property in order to buy, you ideally need to be on the market at least (and preferably Sold STC) before viewing, otherwise you may lose out to other buyers when the right property comes along. In these circumstances we can get your property 'live' quickly. Just book a free valuation and we will visit your property and discuss your needs.

Need a solicitor?

A good solicitor can save you literally weeks of time in the buying/selling process, reducing the stress levels of all involved. We will instruct a reputable firm that is competitive on cost and very reliable. Just ask for a quote.

Need a removal company and storage?

A professional removal company takes the stress out of moving. Knowing that your belongings are safe and insured far outweighs any small savings by trying to do it yourself or using a man-and-a-van service. We work closely with and recommend Cube Removals as the leading local firm. For peace of mind and a reliable service call them on 0800 193 0000 or visit their website, [cuberemovals.co.uk](http://cuberemovals.co.uk), to arrange a survey.

GROUND FLOOR  
720 sq.ft. (66.9 sq.m.) approx.

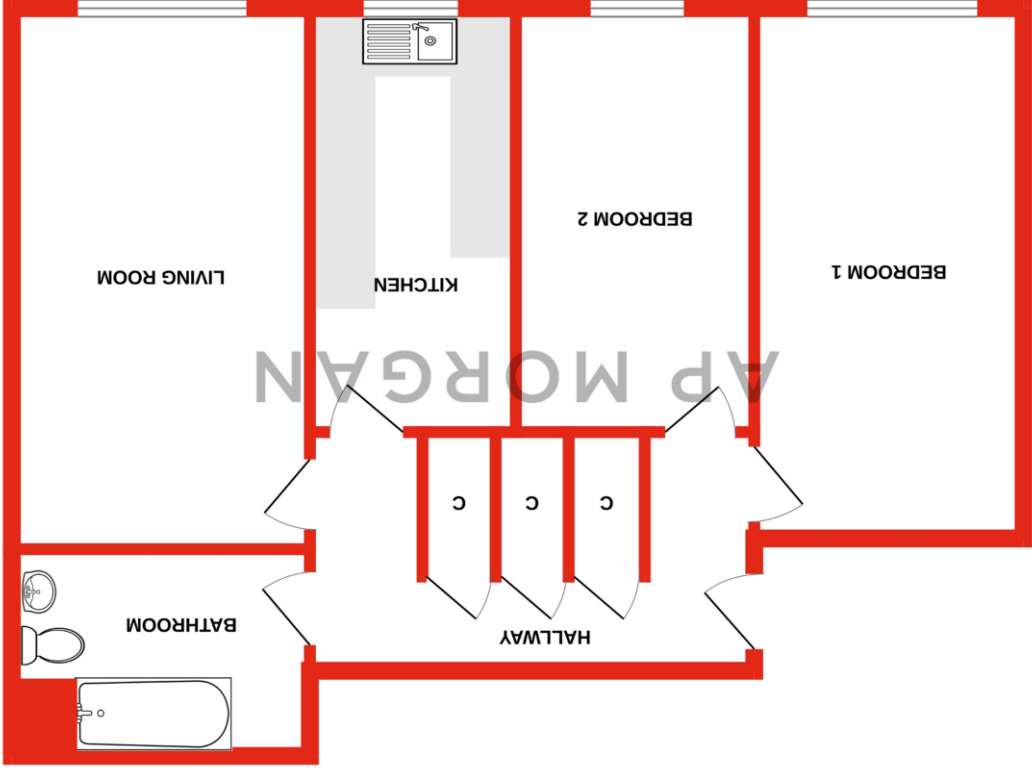

While every attempt has been made to ensure the accuracy of the layout contained here, measurements of doors, windows, rooms and any other items are approximate and no responsibility is taken for any error, omission or mis-statement. This plan is for illustrative purposes only and should be used as such by any prospective purchaser. The services, systems and appliances shown have not been tested and no guarantee as to their operability or efficiency can be given.  
Made with Hktopix ©2024

No statement in these details is to be relied upon as representation of fact, and purchasers should satisfy themselves by inspection or otherwise as to the accuracy of the statements contained within. These details do not constitute any part of any offer or contract. AP Morgan and their employees and agents do not have any warranty or representation whatsoever in respect of this property. These details and all statements herein are provided without any responsibility on the part of AP Morgan or the vendors. Equipment: AP Morgan has not tested the equipment or central heating system mentioned in these particulars and the purchasers are advised to satisfy themselves as to the working order and condition. Measurements: Great care is taken when measuring, but measurements should not be relied upon for ordering carpets, equipment, etc. The Laws of Copyright protect this material. AP Morgan is the Owner of the copyright. This property sheet forms part of our database and is protected by the database right and copyright laws. No unauthorised copying or distribution without permission.